

| Pos. Nr. Pos.no. | Beschreibung Description | Art.-Nr. Art.no. | Preisgruppe Price bracket |
|---------------------|--|---------------------|------------------------------|
| 7500056 | DB Br 141 | = | |
| 7510056 | | = | 🔊 |
| 7520056 | | ~ | 🔊 |
| 1 | Gehäuse komplett Betr.nr. 141 278-2 Body assembly Loco. no.141 278-2 | 150590 | 33 |
| 2 | Schraube M2x6 mm Screw | 85672 | 3 |
| 3 | Platine Printed circuit | 135142 | 21 |
| 4 | Lokpfeife Loco whistle | 88002 | 6 |
| 5 | Isolatorsatz Insulator set | 88018 | 10 |
| 6 | Puffer flach Metall Buffer flat | 88502 | 5 |
| 7 | Puffer gewölbt Metall Buffer vaulted | 88503 | 5 |
| 8 | E-Lokführer E-Loeco driver | 89732 | 6 |
| 9 | Leitungsatz Tube set | 93883 | 8 |
| 10 | Lüftergitter Fan gate | 100603 | 4 |
| 11 | TS-Frontgriffe Part set-Front handles | 146585 | 6 |
| 12 | Topf Can | 142059 | 4 |
| 13 | Kühlschlange Cooling coil | 114624 | 4 |
| 14 | Frontgriff Front handle | 116084 | 3 |
| 15 | Brückenstecker Jumper | 133241 | 10 |
| 16 | Motordistanzplatte Motor spacer plate | 135140 | 4 |
| 17 | Grundrahmen Base frame | 135137 | 16 |
| 18 | TS - Hornbefestigung Part set - Horn fastening | 150593 | 5 |
| 19 | TS- Beleuchtung Part set -Lighting | 135153 | 8 |
| 20 | Aufsatz für Kühler Top for cooler | 135154 | 5 |
| 21 | GF-Schraube M2x5 mm GF-Screw | 114966 | 3 |
| 22 | TS - Batteriekasten-Druckluftkesselsatz Part set - Batteriebox,boiler | 135141 | 9 |
| 23 | Stromabnehmer Pantograph | 85429 | 19 |
| 24 | TS-Lichtabdeckung Part set light cover | 135138 | 6 |
| 25 | Stirnfenster Front window | 135152 | 5 |
| 26 | Führerstand Drivers cab | 135202 | 5 |
| 27 | TS-Gehäuse lackiert Part set body coated | 135155 | 10 |
| 28 | Türgriffstange lackiert Door handle bar coated | 150589 | 6 |
| 29 | Scheibenwischer Windscreen wiper | 135157 | 7 |
| 30 | Fronttreppe lackiert Front step coated | 135158 | 5 |
| 31 | Antenne Antenna | 150591 | 3 |
| 32 | Auftritt Step | 150592 | 3 |
| 33 | Griff unten Lower handrail | 109104 | 3 |
| 34 | UIC-Dose UIC-socket | 129856 | 3 |
| 35 | Hauptschalter Mains switch | 100775 | 4 |
| 36 | Attrappenrahmen klein Push in part set, small | 107808 | 4 |
| Sound | | | |
| 37 | Platine Printed circuit | 135162 | 23 |
| 38 | Sounddecoder Sounddecoder | 147377 | 39 |
| 39 | Lautsprecher Loudspeaker | 129524 | 13 |
| 40 | Lautsprecherbox Loudspeaker box | 135163 | 4 |

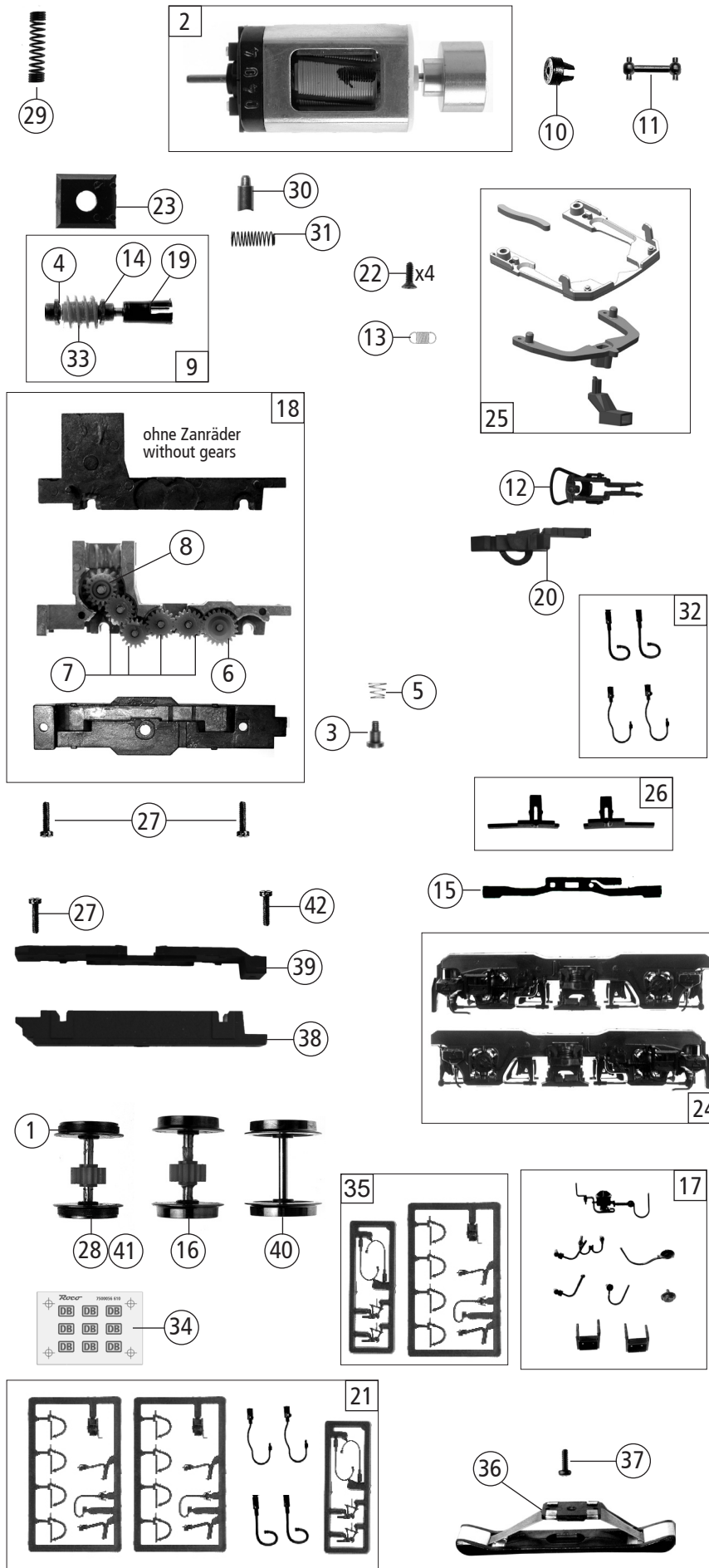

| Pos. Nr. Pos.no. | Beschreibung Description | Art.-Nr. Art.no. | Preisgruppe Price bracket |
|--------------------------|--|---------------------|------------------------------|
| 7500056 | DB Br 141 | = | |
| 7510056 | | = | 🔊 |
| 7520056 | | ~ | 🔊 |
| 1 | Haftringsatz 10 Stk. 12,9 - 14,6mm Set with traction tires 10 pieces | 40070 | --- |
| 2 | Motor Motor | 85060 | 28 |
| 3 | FK - Schraube M2x3,5/7,5 mm GF - Screw | 85771 | 4 |
| 4 | Beilagscheibe Washer | 86108 | 3 |
| 5 | Feder Spring | 86202 | 3 |
| 6 | Zahnrad Z=21 Gearwheel | 86414 | 3 |
| 7 | Zahnrad Z=17 Gearwheel | 86418 | 5 |
| 8 | Schnecken Zahnrad doppelt Worm gear double | 86419 | 6 |
| 9 | Schneckensatz Worm set | 86865 | 13 |
| 10 | Kardanschale kurz 1,5mm Cardan bearing short | 87129 | 4 |
| 11 | Kardanwelle Cardan shaft | 87154 | 3 |
| 12 | Standardkupplung Standard coupling | 89246 | 6 |
| 13 | Zugfeder Spring | 86208 | 3 |
| 14 | Lager für Schneckenachse Bearing for worm axle | 89749 | 6 |
| 15 | Kontakt Contact | 89960 | 6 |
| 16 | Radsatz m. Zahnrad o. Haftring Wheelset w. gearwh. w/o traction tyre | 135147 | 11 |
| 17 | Blendensatz Bogie parts set | 135146 | 10 |
| 18 | TS-Getriebe Part set gear | 135143 | 13 |
| 19 | Kardanschale Cardan bearing | 87134 | 4 |
| 20 | Kurzkupplung Short coupling | 115550 | 6 |
| 21 | Zurüstbeutel Bag with accessories | 135151 | 14 |
| 22 | SK-Schraube M1,6x5 mm SK-Screw | 115317 | 4 |
| 23 | Schneckendeckel Worm cover | 94679 | 4 |
| 24 | Blende 1 u. 2 Bogie frame 1 a. 2 | 135145 | 19 |
| 25 | TS-Kinematik, Deichsel Part set | 135139 | 8 |
| 26 | Kontaktaltersatz Contact holder set | 135144 | 6 |
| 27 | GF-Schraube M2x8 mm GF-Screw | 114923 | 3 |
| 28 | Radsatz m. Zahnrad m. 2Haftringe Wheelset w. gearwh. w. 2traction tyres | 135148 | 12 |
| 29 | Motorkontaktfeder Spring | 116812 | 3 |
| 30 | Kohlebürste Carbon brush | 89743 | 6 |
| 31 | Bürstenfeder Brush spring | 114197 | 3 |
| 32 | TS-Heizschlauch und Kupplung Part set of heating hose and coupling | 116227 | 3 |
| 33 | Schnecke Wormgear | 86704 | 6 |
| 34 | Decal-Aufkleber Decal-Stickers | 150594 | 11 |
| 35 | Zubehörrahmen gr+mi Frame with accessories | 108322 | 7 |
| AC - Wechselstrom | | | |
| 36 | Schleifer 46 mm Slider | 86031 | 14 |
| 37 | GF-Schraube M1,6x5 mm GF-Screw | 115269 | 3 |
| 38 | Drehgestell AC Gear bottom | 135165 | 10 |
| 39 | Getriebedeckel AC Gear cover | 135166 | 6 |
| 40 | Radsatz o. Zahnrad o. Haftring Wheelset w/o gearwh. w/o traction tyre | 135167 | 10 |
| 41 | Radsatz m. Zahnrad m. 2Haftringe Wheelset w. gearwh. w. 2traction tyres | 135168 | 12 |
| 42 | GF-Schraube M2x6 mm GF-Screw | 114828 | 3 |